

LAND FOR SALE

Bowser - Hillman Farm



Location: On Road 149 five miles south of I-80 Exit #76 Lodgepole, Nebraska or 3 south, 8 west of Chappell.

Description: SW1/4 Section 1, W1/2 Section 12-T12N-R47W of the 6th PM Cheyenne County, Nebraska.
1/2 mile west of Deuel County, 1 mile north of Colorado at Road 149, Road 6.

Acres/Taxes: 479.8 tax assessed acres; 2019 taxes \$2,727.

Soils: Cropland soils predominantly Class II Keith-Kuma-Satanta loams, 1-3% slopes;
range and CRP areas mostly Class IV and VI soils.

FSA Info: 326 cropland acres: with 182.5 acres Wheat Base @ 34 bu yield, 7.1 acres Corn Base @ 100 bu .;
35.68 acres CRP @ \$29/per acre through 9/30/2030 100% payment to owner.

Buildings: Property does not include any building improvements.

Comments: County Road 149 along west boundary provides excellent access. Remaining acres
are rangeland or CRP. Livestock well in center Section 12 has pipeline to
tank in Section 1. Excellent Class II cropland soils. CRP payment 100% to owner.
This farm has been in the same family for over 134 years.

Price: \$260,000 Cash

Contact: John Childears 308/539-4450 john@agriaffiliates.com
Don Walker 308/764-7175 Mike Polk 308/539-4446
Roger Luehrs, Brad Atkins, Chase Dodson, Bruce Dodson,
Brian Reynolds, Tony Eggleston



John Childears,
Listing Agent

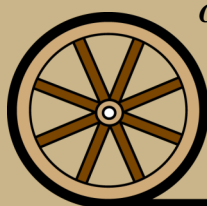

Offered Exclusively By:

AGRI AFFILIATES, INC.
Providing Farm - Ranch Real Estate Services

Information contained herein was obtained from sources deemed reliable. We have no reason to doubt the accuracy, but the information is not guaranteed. Prospective Buyers should verify all information. All maps provided by Agri Affiliates, Inc. are approximations only, to be used as a general guideline, and not intended as survey accurate. As with any agricultural land, this property may include noxious weeds. Agri Affiliates, Inc. and all agents are acting as Agent of the Seller.

NORTH PLATTE OFFICE
P.O. Box 1166
I-80 & US Hwy 83
North Platte, NE 69103
www.agriaffiliates.com
(308) 534-9240
Fax (308) 534-9244

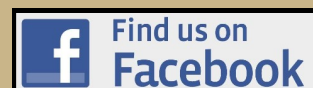

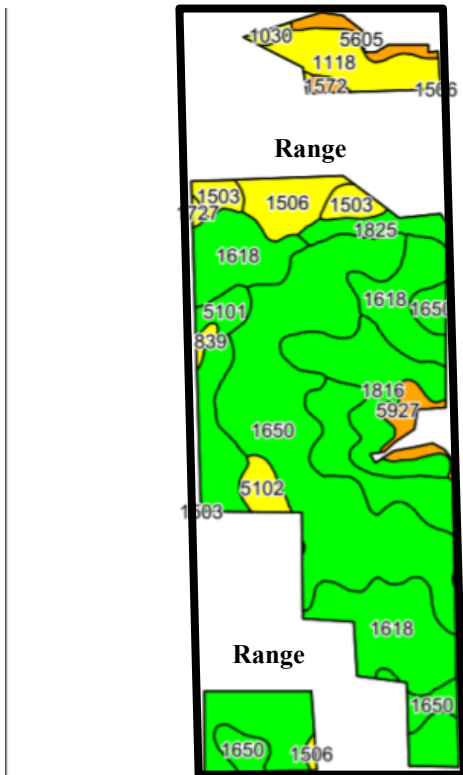
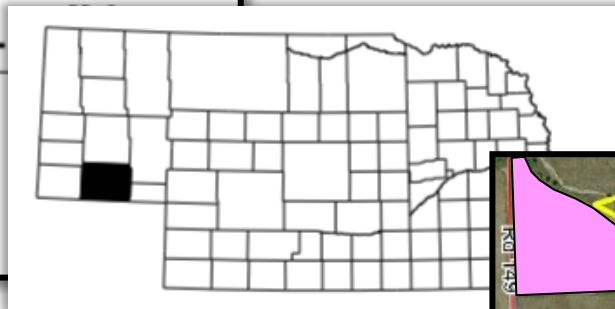
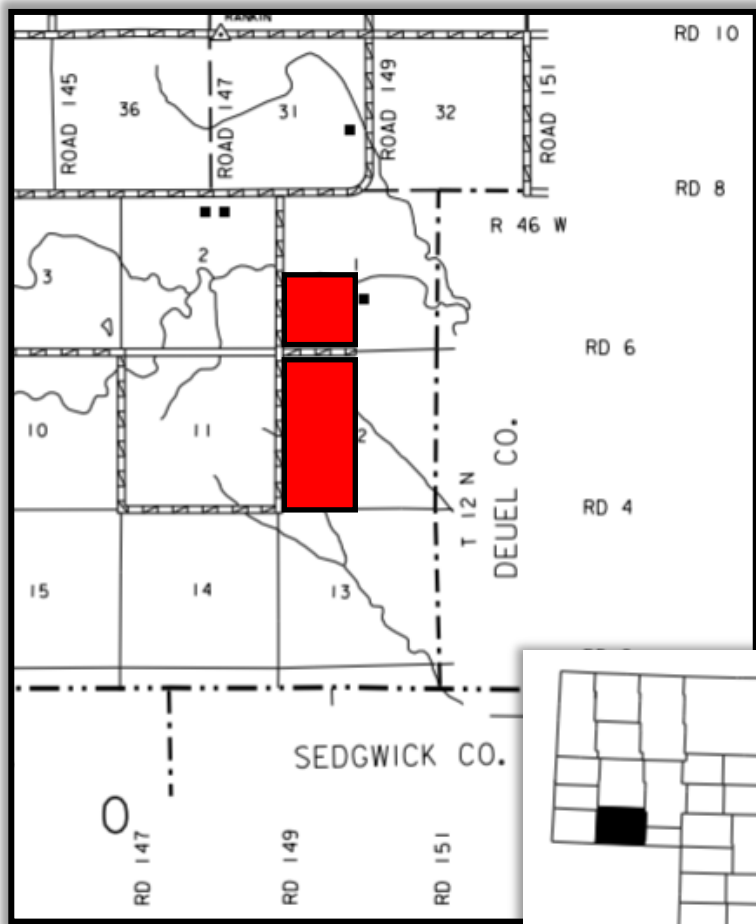

Pink fields are CRP. 



Blue dotted line is water pipeline.



©2019 AgriData, Inc.

Soils data provided by USDA and NRCS.

Area Symbol: NE033, Soil Area Version: 19

Code	Soil Description	Acres	Percent of field	Non-Irr Class Legend	Non-Irr Class *c
1618	Keith loam, 1 to 3 percent slopes	112.73	37.1%		lle
1650	Kuma loam, 0 to 1 percent slopes	99.20	32.6%		llc
1816	Satanta loam, gravelly substratum, 1 to 3 percent slopes	25.94	8.5%		lle

